

# Evolve™ LED Area Light

N Series (EANB)



**current**  
powered by GE

## Product Features

The next generation of the GE Evolve™ LED Area Light is an exciting solution to efficiently illuminate site and area applications. The smaller-form design of the EANB fixture provides superior illuminance at impressive site ROIs. The exclusive optical ring design effectively directs the light and produces impressive vertical illuminance and glare control. Additionally, the Evolve LED Area Light provides significant operating cost benefits over the life of each fixture with reduced energy consumption and a long rated life that virtually eliminates ongoing maintenance expenses.

### Applications

- Site, area, roadway and general lighting applications utilizing advanced LED optical system providing high uniformity, excellent vertical light distribution, reduced offsite visibility, reduced on-site glare and effective security light levels.
- Obtain a truly optimized and efficient parking space with dimming and occupancy sensing features.

### Housing

- Die-cast aluminum housing.
- Slim architectural design incorporates an integral heat sink and light engine, ensuring maximum heat transfer, long LED life, and a reduced Effective Projected Area (EPA).
- Meets 2G vibration level per ANSI C136.31-2010.

### LED & Optical Assembly

- Structured LED arrays for optimized area light photometric distribution.
- Evolve light engine with directional reflectors designed to optimize application efficiency and minimize glare.
- Utilizes high brightness LEDs, 70 CRI at 3000K, 4000K and 5000K typical.

### Lumen Maintenance

- Projected L90>50,000 hours per IES TM-21
- Projected Lxx per IES TM-21 at 25°C for reference:

SKU	LXX (10K)@HOURS		
	25,000 HR	50,000 HR	100,000 HR
EANB	L98	L95	L90

NOTES: 1) Projected Lxx based on LM-80 (10,000 hour testing).  
2) DOE Lighting Facts Verification Testing Tolerances apply to initial luminous flux and lumen maintenance measurements.

### Lumen Ambient Temperature Factors:

LUMEN AMBIENT TEMPERATURE FACTORS:	
AMBIENT TEMPERATURE (°C)	INITIAL FLUX FACTOR
10	1.02
20	1.01
25	1.00
30	0.99
40	0.98
50	0.97

### Ratings

- UL/cUL listed, suitable for wet locations.
- IP66 rated optical enclosure per ANSI C136.25-2009.
- Temperature rated at -40° to 50°C.
- Upward Light Output Ratio (ULOR) = 0.
- Title 24 compliant with "H" motion sensor option.
- Compliant with the material restriction requirements of RoHS.



### Mounting

#### Option A

- 10-inch (254mm) mounting arm for square pole prewired with 24-inch (610mm) leads.

#### Option B

- 10-inch (254mm) mounting arm for round pole prewired with 24-inch (610mm) leads.

#### Option C

- Slipfitter mounting for 2 3/8-inch (60mm) O.D. pipe prewired with 24-inch (610mm) leads.

#### Option D

- 10-inch (254mm) mounting arm for round or square pole prewired with 24-inch (610mm) leads.

### Finish

- Corrosion resistant polyester powder painted, minimum 2.0 mil. thickness.
- Standard colors: Black & Dark Bronze.
- RAL & custom colors available.

### Electrical

- 120-277 VAC and 347-480 VAC available.
- System power factor is >90% and THD <20%.
- ANSI C136.41 7-pin dimming receptacle, standard.
- ANSI photo electric sensors (PE) available for all voltages. Light Grid compatible.
- Dimming/Occupancy:
  - Wired 0-10V continuous dimming
  - DALI digital dimming. Contact manufacturer for availability.
  - Standalone motion sensor based dimming using "H" option code.
- Surge Protection per ANSI C136.2-2015.
  - 6kV/3kA "Basic" surge protection, standard.
  - 10kV/5kA "Enhanced" surge protection optional.

### Accessories

- PE Accessories - See Page 3



DLC Standard qualified models available. Please refer to <http://www.designlights.org/QPL> for complete information.

# Ordering Number Logic

## Evolve™ LED Area Light N Series (EANB)



**E A N B**      **7**

PROD. ID	PHOTOMETRIC SERIES	VOLTAGE	OPTICAL CODE	CRI	LED COLOR TEMP	PE FUNCTION	MOUNTING ARM	COLOR	OPTIONS
<b>E</b> = Evolve <b>A</b> = Area Light <b>N</b> = Housing Series	<b>B</b> = Photometric Series "B"	<b>0</b> = 120-277* <b>1</b> = 120 <b>2</b> = 208 <b>3</b> = 240 <b>4</b> = 277 <b>5</b> = 480 <b>D</b> = 347 <b>H</b> = 347-480V*		<b>7</b> = 70 (min)	<b>30</b> = 3000K° <b>40</b> = 4000K <b>50</b> = 5000K ◁Select 3000K CCT for IDA Approved units	<b>1</b> = None <b>A</b> = ANSI C136.41 7-pin PE Receptacle # <b>D</b> = ANSI C136.41 7-pin PE Receptacle with Shorting Cap #  # Order Dimming/Control PE as a separate item. See accessories section of this datasheet for ordering information.	<b>A</b> = 10" Arm for Square Pole, supplied with leads <b>B</b> = 10" Arm for Round Pole, supplied with leads <b>C</b> = EXT Slipfitter 2" Pipe (2.378 in. OD) supplied with leads <b>D</b> = 10" Arm for Round or Square poles, supplied with leads and additional hardware	<b>BLCK</b> = Black <b>DKBZ</b> = Dark Bronze <b>GRAY</b> = Gray <b>WHITE</b> = White  Contact manufacturer for other colors.	<b>D</b> = External Dimming Leads Provided (0-10Volt Input) <b>F</b> = Fusing <b>L</b> = Tool less entry <b>R</b> = 10kV Enhanced Surge Protection <b>H</b> = Motion Sensor *# <b>U</b> = DALI Dimming+^ <b>XXX</b> = Special Options  * May only be selected in conjunction with A, B or D Mounting Arm. # R & H options cannot be purchased together. + Compatible with LightGrid 2.0 nodes. ^ Not compatible at 347-480V, with A-level optical code, or with motion sensor control.



	OPTICAL CODE	TYPE	TYPICAL INITIAL LUMENS		TYPICAL SYSTEM WATTAGE	BUG RATING		IES FILE NUMBER		
			3000K	4000K & 5000K		3000K B-U-G	4000K & 5000K B-U-G	3000K	4000K	5000K
TYPE IV	A4	Asymmetric Forward	4,000	4,300	44	B1-U0-G1	B1-U0-G1	EANB_A4730__IES	EANB_A4740__IES	EANB_A4750__IES
	B4	Asymmetric Forward	5,800	6,200	58	B1-U0-G2	B1-U0-G2	EANB_B4730__IES	EANB_B4740__IES	EANB_B4750__IES
	C4	Asymmetric Forward	7,500	8,000	70	B1-U0-G2	B1-U0-G2	EANB_C4730__IES	EANB_C4740__IES	EANB_C4750__IES
	D4	Asymmetric Forward	9,200	9,800	89	B1-U0-G2	B2-U0-G2	EANB_D4730__IES	EANB_D4740__IES	EANB_D4750__IES
	E4	Asymmetric Forward	10,800	11,500	98	B2-U0-G2	B2-U0-G2	EANB_E4730__IES	EANB_E4740__IES	EANB_E4750__IES
	F4	Asymmetric Forward	12,900	13,700	125	B2-U0-G3	B2-U0-G3	EANB_F4730__IES	EANB_F4740__IES	EANB_F4750__IES
TYPE III	A3	Asymmetric Wide	4,300	4,600	44	B1-U0-G1	B1-U0-G1	EANB_A3730__IES	EANB_A3740__IES	EANB_A3750__IES
	B3	Asymmetric Wide	6,200	6,600	58	B1-U0-G1	B1-U0-G1	EANB_B3730__IES	EANB_B3740__IES	EANB_B3750__IES
	C3	Asymmetric Wide	8,100	8,600	70	B1-U0-G2	B1-U0-G2	EANB_C3730__IES	EANB_C3740__IES	EANB_C3750__IES
	D3	Asymmetric Wide	9,900	10,500	89	B2-U0-G2	B2-U0-G2	EANB_D3730__IES	EANB_D3740__IES	EANB_D3750__IES
	E3	Asymmetric Wide	11,600	12,400	98	B2-U0-G2	B2-U0-G2	EANB_E3730__IES	EANB_E3740__IES	EANB_E3750__IES
	F3	Asymmetric Wide	13,900	14,700	125	B2-U0-G2	B2-U0-G2	EANB_F3730__IES	EANB_F3740__IES	EANB_F3750__IES
TYPE II	A2	Asymmetric Narrow	4,200	4,500	44	B1-U0-G1	B1-U0-G1	EANB_A2730__IES	EANB_A2740__IES	EANB_A2750__IES
	B2	Asymmetric Narrow	6,100	6,500	58	B1-U0-G1	B1-U0-G1	EANB_B2730__IES	EANB_B2740__IES	EANB_B2750__IES
	C2	Asymmetric Narrow	7,900	8,400	70	B2-U0-G2	B2-U0-G2	EANB_C2730__IES	EANB_C2740__IES	EANB_C2750__IES
	D2	Asymmetric Narrow	9,700	10,300	89	B2-U0-G2	B2-U0-G2	EANB_D2730__IES	EANB_D2740__IES	EANB_D2750__IES
	E2	Asymmetric Narrow	11,400	12,100	98	B2-U0-G2	B2-U0-G2	EANB_E2730__IES	EANB_E2740__IES	EANB_E2750__IES
	F2	Asymmetric Narrow	13,600	14,400	125	B2-U0-G2	B2-U0-G2	EANB_F2730__IES	EANB_F2740__IES	EANB_F2750__IES

### PE Accessories (to be ordered separately)

SAP Number	Part Number	Description
93029237	PED-MV-LED-7	ANSI C136.41 Dimming PE, 120-277V
93029238	PED-347-LED-7	ANSI C136.41 Dimming PE, 347V
93029239	PED-480-LED-7	ANSI C136.41 Dimming PE, 480V

SAP Number	Part Number	Description
28299	PECOTL	STANDARD 120-277V
28294	PEC5TL	STANDARD 480V
80436	PECDTL	STANDARD 347V
73251	SCCL-PECTL	Shorting cap

# Photometrics

**EANB Type IV - Asymmetric Forward (F4)**  
 13,700 Lumens, 5000K (EANB\_F4750\_\_\_.IES)

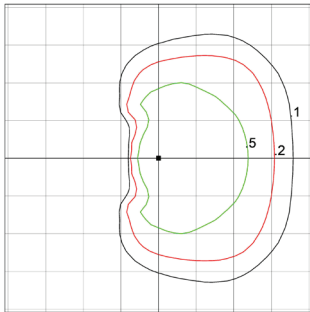

Grid Distance in Units  
 of Mounting Height at 30' Initial  
 Footcandle Values at Grade

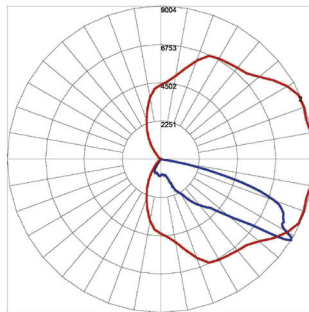

— Vertical plane through horizontal angle  
 of maximum candlepower at 45°  
 — Vertical plane through horizontal angle of 72.5°

**EANB Type IV - Asymmetric Forward (A4)**  
 4,300 Lumens, 5000K (EANB\_A4750\_\_\_.IES)

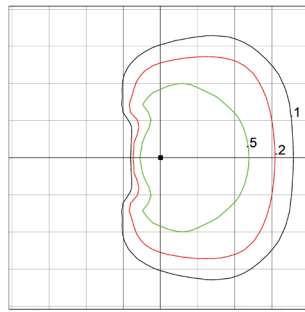

Grid Distance in Units  
 of Mounting Height at 15' Initial  
 Footcandle Values at Grade

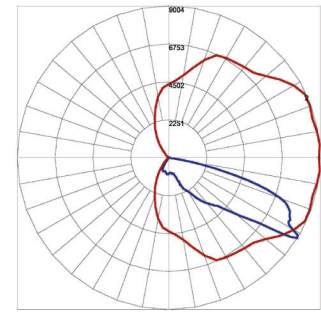

— Vertical plane through horizontal angle  
 of maximum candlepower at 45°  
 — Vertical plane through horizontal angle of 72.5°

**EANB Type III - Asymmetric Wide (F3)**  
 14,700 Lumens, 5000K (EANB\_F3750\_\_\_.IES)

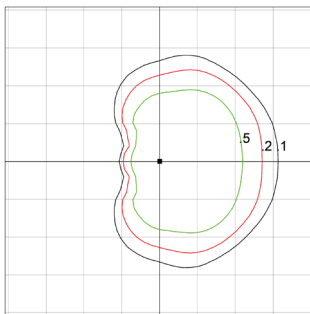

Grid Distance in Units  
 of Mounting Height at 30' Initial  
 Footcandle Values at Grade

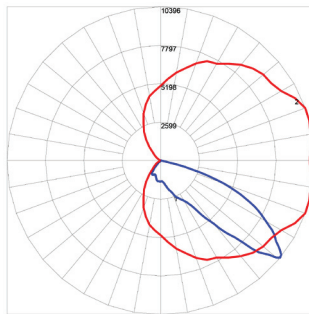

— Vertical plane through horizontal angle  
 of maximum candlepower at 20°  
 — Vertical plane through horizontal angle of 52.5°

**EANB Type III - Asymmetric Wide (A3)**  
 4,600 Lumens, 5000K (EANB\_A3750\_\_\_.IES)

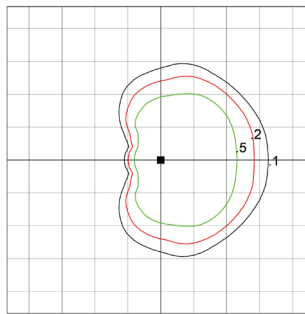

Grid Distance in Units  
 of Mounting Height at 15' Initial  
 Footcandle Values at Grade

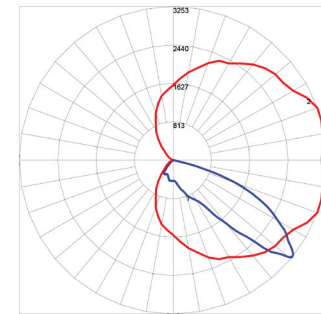

— Vertical plane through horizontal angle  
 of maximum candlepower at 20°  
 — Vertical plane through horizontal angle of 52.5°

**EANB Type II - Asymmetric Narrow (F2)**  
 14,400 Lumens, 5000K (EANB\_F2750\_\_\_.IES)

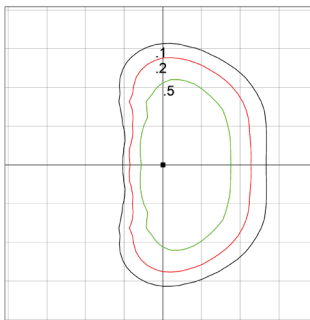

Distance in Units  
 of Mounting Height at 30' Initial  
 Footcandle Values at Grade

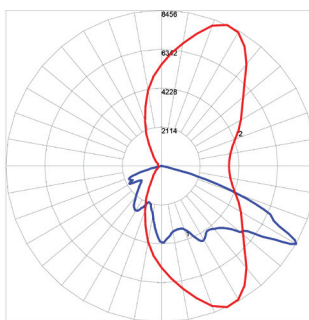

— Vertical plane through horizontal angle  
 of maximum candlepower at 65°  
 — Vertical plane through horizontal angle of 60°

**EANB Type II - Asymmetric Narrow (A2)**  
 4,500 Lumens, 5000K (EANB\_A2750\_\_\_.IES)

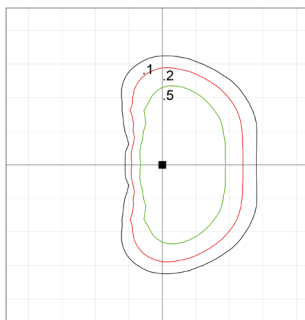

Grid Distance in Units  
 of Mounting Height at 15' Initial  
 Footcandle Values at Grade

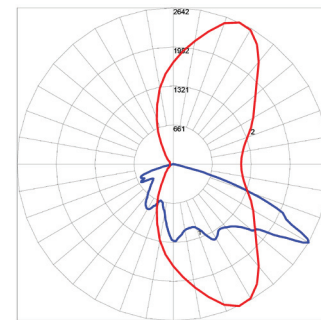

— Vertical plane through horizontal angle  
 of maximum candlepower at 65°  
 — Vertical plane through horizontal angle of 60°

# Product Dimensions

10" Arm For Square Pole Mount (Option A)

10" Arm For Round Pole Mount (Option B)

10" Arm For Square Pole Mount or Round Pole Mount (Option D)

Option D includes all mounting hardware in Option A and Option B

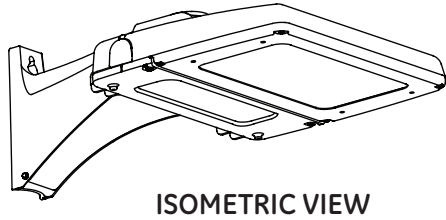

ISOMETRIC VIEW

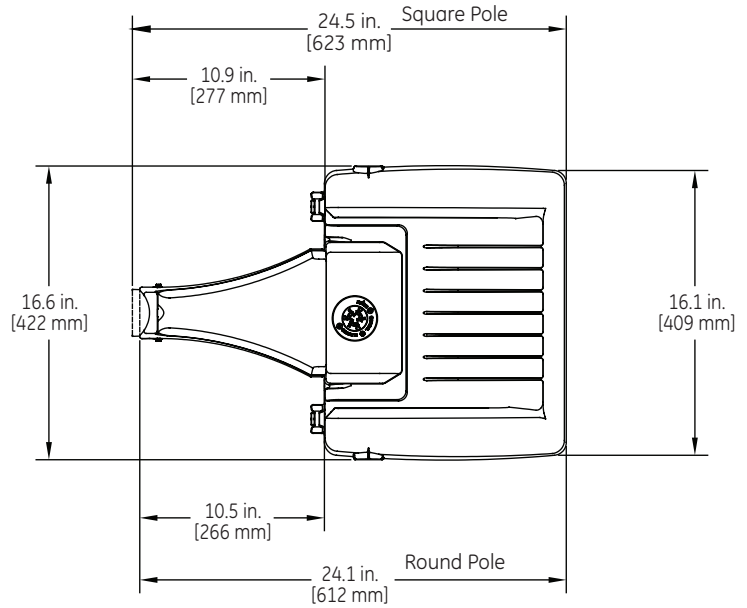

TOP VIEW

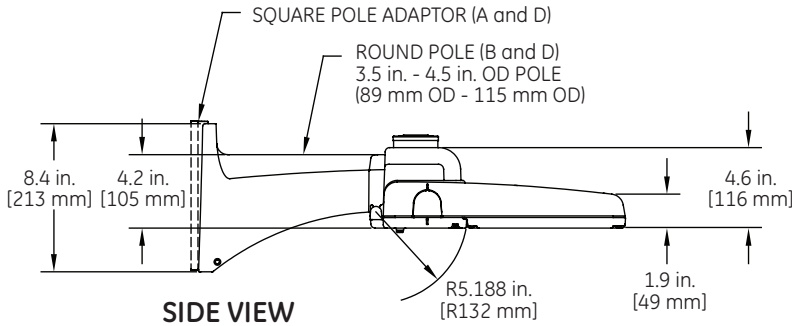

SIDE VIEW

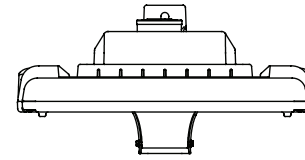

FRONT VIEW

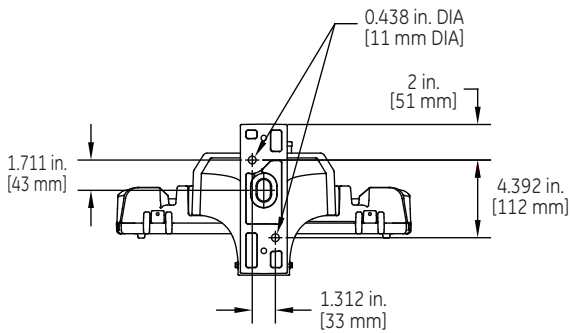

BACK VIEW

Option A and D Square Pole  
3.5 in. - 4.5 in POLE  
(89 mm - 115 mm)

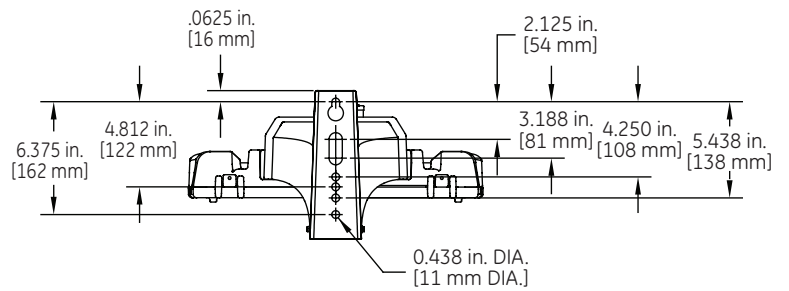

BACK VIEW

Option A and D Round Pole  
3.5 in. - 4.5 in OD POLE  
(89 mm OD - 115 mm OD)

**DATA**

- Approximate net weight: 20 lbs (9.07 kgs)
- Effective Projected Area (EPA) with 10" Mounting Arm: 0.67 sq ft max (0.06 sq m)

# Product Dimensions

## Slipfitter Arm Mount (Option C)

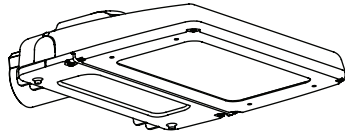

ISOMETRIC VIEW

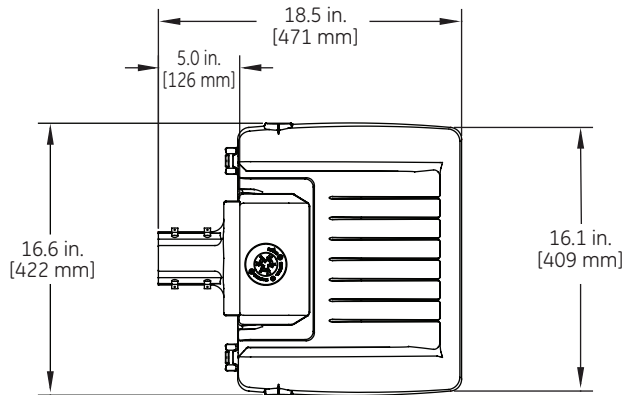

TOP VIEW

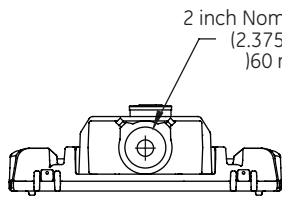

BACK VIEW

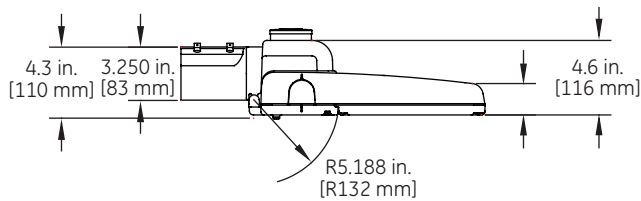

SIDE VIEW

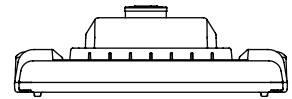

FRONT VIEW

DATA

- Approximate net weight: 19 lbs (8.61 kgs)
- Effective Projected Area (EPA) with Slipfitter: 0.43 sq ft max (0.04 sq m)

## H-Motion Sensing Option:

- Intended for high mounting applications, between 15-30ft (4.57-9.14m). For mounting heights exceeding 30ft, pole mounted sensors are recommended.
- Provides a coverage area radius for walking motion of 15-20ft (4.57-6.10m).
- Provides 270° of coverage (~90° is blocked by the pole).
- Comes standard with 50% dimmed light output with no occupancy, and full power at occupancy.
- Comes standard with photocell function. Note: It is not necessary to also purchase PE receptacle or control.
- Comes standard with a 5 minute occupancy time delay and a 5 minute ramp-down to the 50% dimmed level.
- Must order with decorative mounting arm options "A" or "B".
- Fixture power increase of 1W expected with sensor use.

Note: Standard options may be reprogrammed in the field. Reprogramming instructions included in product shipment.

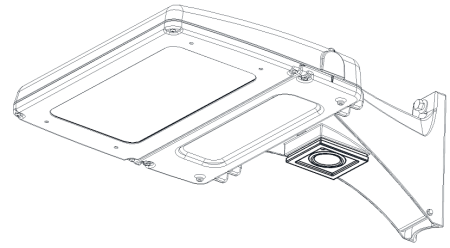

## Sensor Pattern:

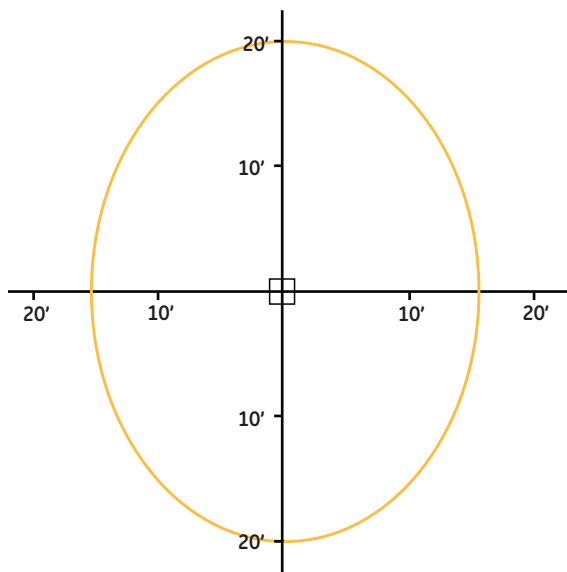

**Sensing Pattern Area Fixture  
Up to 30 ft.**

# Mounting Information

## Mounting Arms for Slipfitter

Order separately with Mounting Option C (External Slipfitter)

### SQUARE POLE MOUNTING ARM

3.5 TO 4.5-inch (89 to 114mm) SQUARE  
(WILL ALLOW 4 FIXTURES PER POLE @ 90 DEGREES.)

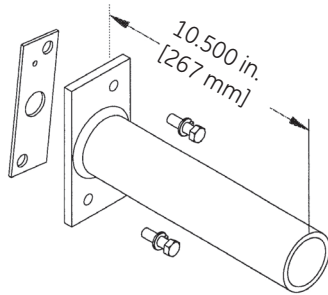

ORDER SEPARATELY FROM FIXTURE AS CATALOG NUMBER  
SPA-EAMT10BLCK "Black"  
SPA-EAMT10DKBZ "Dark Bronze"

### ROUND POLE MOUNTING ARM

3.5 TO 4.5-inch (89 to 114mm) OD  
(WILL ALLOW 4 FIXTURES PER POLE @ 90 DEGREES.)

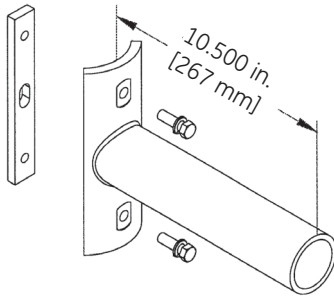

ORDER SEPARATELY FROM FIXTURE AS CATALOG NUMBER  
RPA-EAMT10BLCK "Black"  
RPA-EAMT10DKBZ "Dark Bronze"

## Drilling Templates for Slipfitter Arms & Arm Mount

### SQUARE POLE MOUNTING

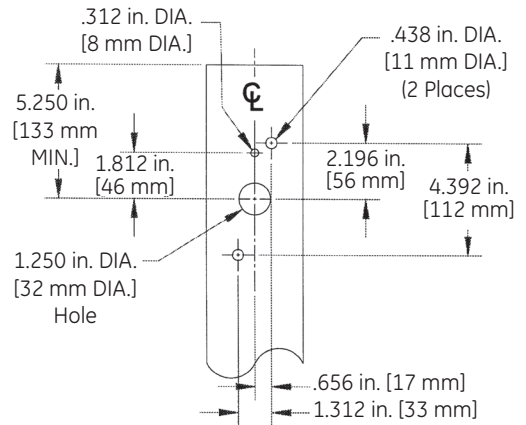

### ROUND POLE MOUNTING

3.5 TO 4.5-inch (89 to 114mm) OD  
round pole mounting arm

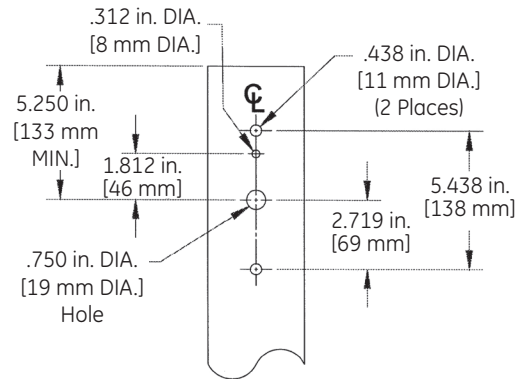

Other mounting patterns are available for retrofit installations.  
Contact manufacturing for other available mounting patterns.



[www.currentbyge.com](http://www.currentbyge.com)

All trademarks are the property of their respective owners. Information provided is subject to change without notice. All values are design or typical values when measured under laboratory conditions. Current, powered by GE is a business of the General Electric Company.  
© 2017 GE.

OLP3118 (Rev 05/04/17)